

How to make a pressure fountain

Make sure that you operate your fountain over a sink or outside!

You will need:

- Large plastic bottle (1-1.25 litre is ideal). Recycle a plastic bottle to give it a second life.
- A paper straw (or bamboo, corn starch or stainless steel straw)
- Sticky tac or similar
- Scissors
- Balloon

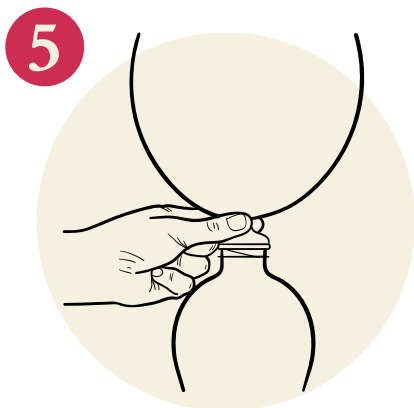

What to do:

- 1 Measure approximately 10cm up the side of the plastic bottle and make a hole. The hole should be the same diameter as the straw.
- 2 Push the straw through the hole as near to the bottom of the bottle as possible, with the outside angled upwards.
- 3 Seal the hole around the straw with sticky tac, or similar, to reduce leakage.
- 4 Half fill the bottle with water. Notice that the water does not come out of the straw.
- 5 Now for the tricky bit. Blow up the balloon and, without letting the air escape, stretch the balloon end over the top of the bottle.
- 6 Hold the balloon in place and then release the air. As the balloon deflates the air pressure will force the water up through the straw to create your very own pressure fountain.

Why does this happen?

The atmosphere surrounding Earth puts pressure on everything. Inside the bottle the water is already under pressure but not enough to force it up the straw. When the air is released from the balloon the air pressure increases, pushing down on the water and forcing it through the straw, creating the fountain.

